

- ⊥ 1-POLE SWITCH 3-3-WAY
- ⊕ DUPLEX OUTLET
- INDICATES GANGING OF DEVICES
- ⊙ SURFACE MOUNTED INCANDESCENT FIXTURE
- RECESSED INCANDESCENT FIXTURE
- ⊕ SURFACE MOUNT FIXTURE
- ⊗ EXIT SIGN
- ⊠ FIRE ALARM PULL STATION
- ⊠ HEAT DETECTOR
- ⊠ SMOKE DETECTOR UNDERLINED = ROOF MOUNTED
- ⊠ HORN

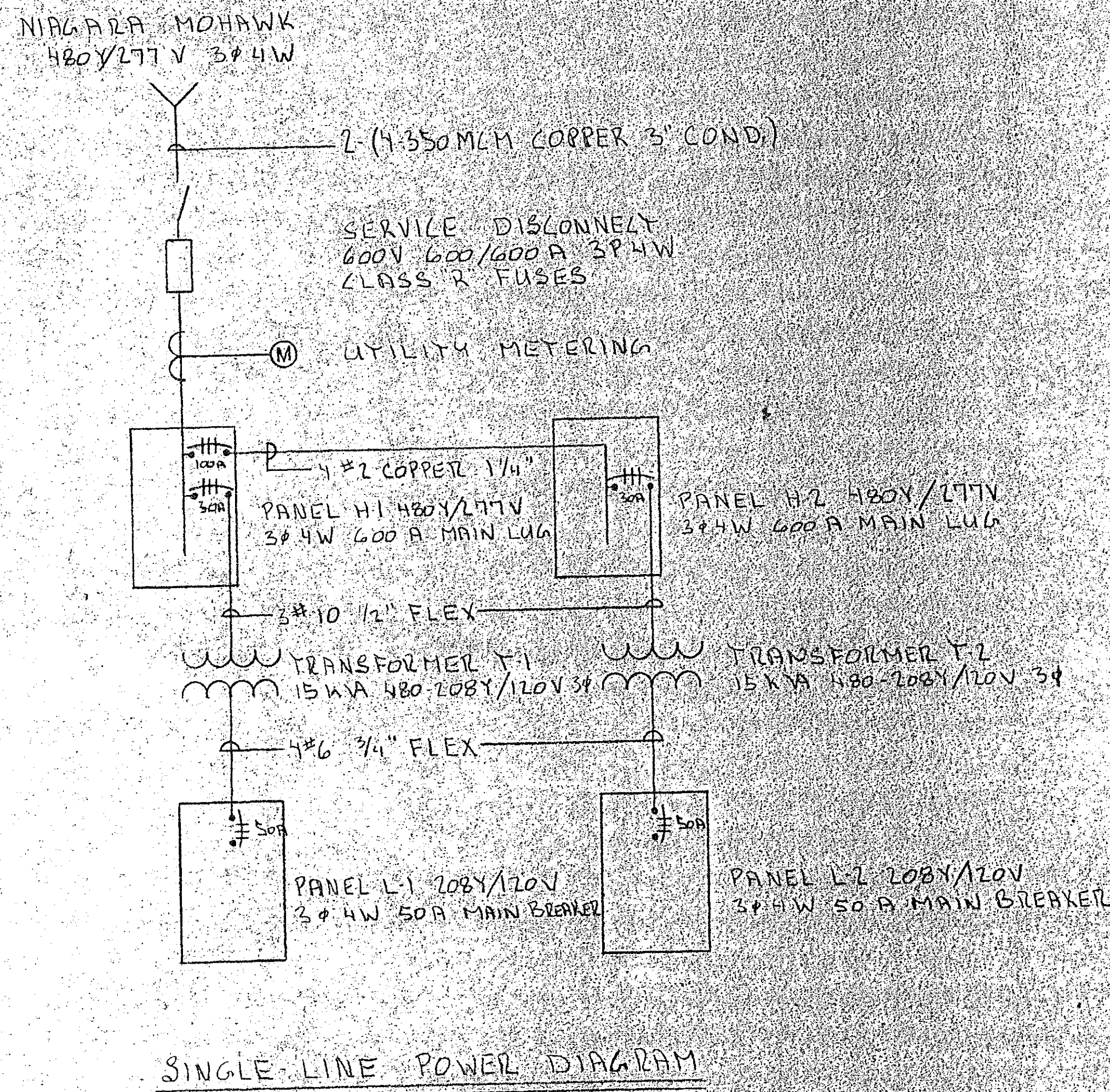

TYPE	VOLTS	DESCRIPTION
A	120	DAMP LOCATION SURF INCAN 100W
B	120	WALL MOUNTED INCAN 100W
C	120	HIGH BAY INCAN 100W
FA	277	VAND. RES. SURF 4-F40
FB	277	SURF WRAP AROUND 4-F40
FC	277	8 STRIP 2-F96
FD	120	3 OVER-MIRROR 2-F50
FE	277	4 STRIP WITH LENS 2-F40
FG	277	2x LAY IN 4-F40
FH	277	2x LAY IN 2-F40
FI	277	2x LAY IN 2-F40
FJ	277	8 STRIP WITH LENS 2-F96
K	120	EXIT SIGN WITH BATTERY
EBU	120	EMERGENCY BATTERY UNIT
HA	277	100W LOW MOUNT METAL HALIDE

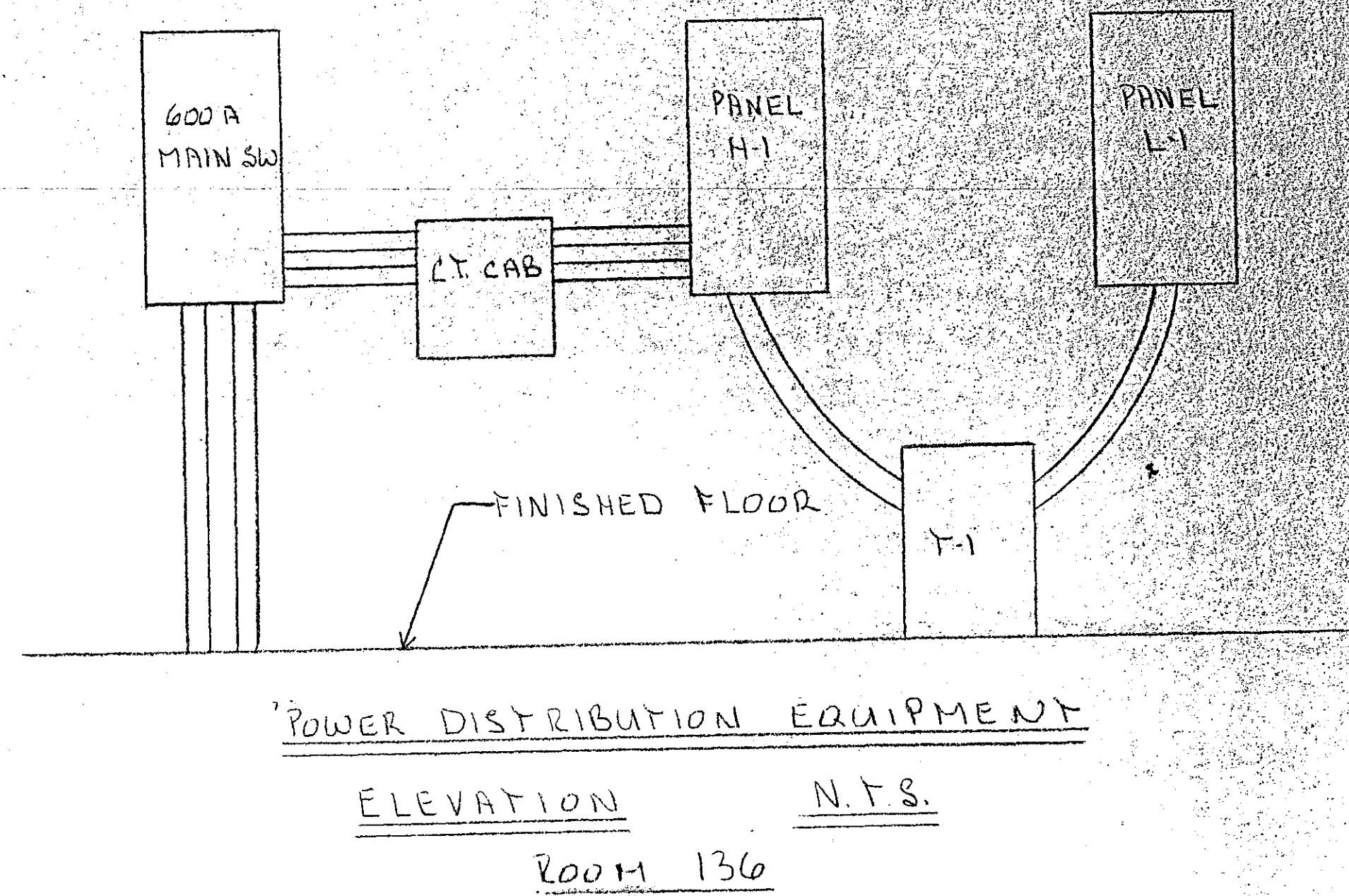
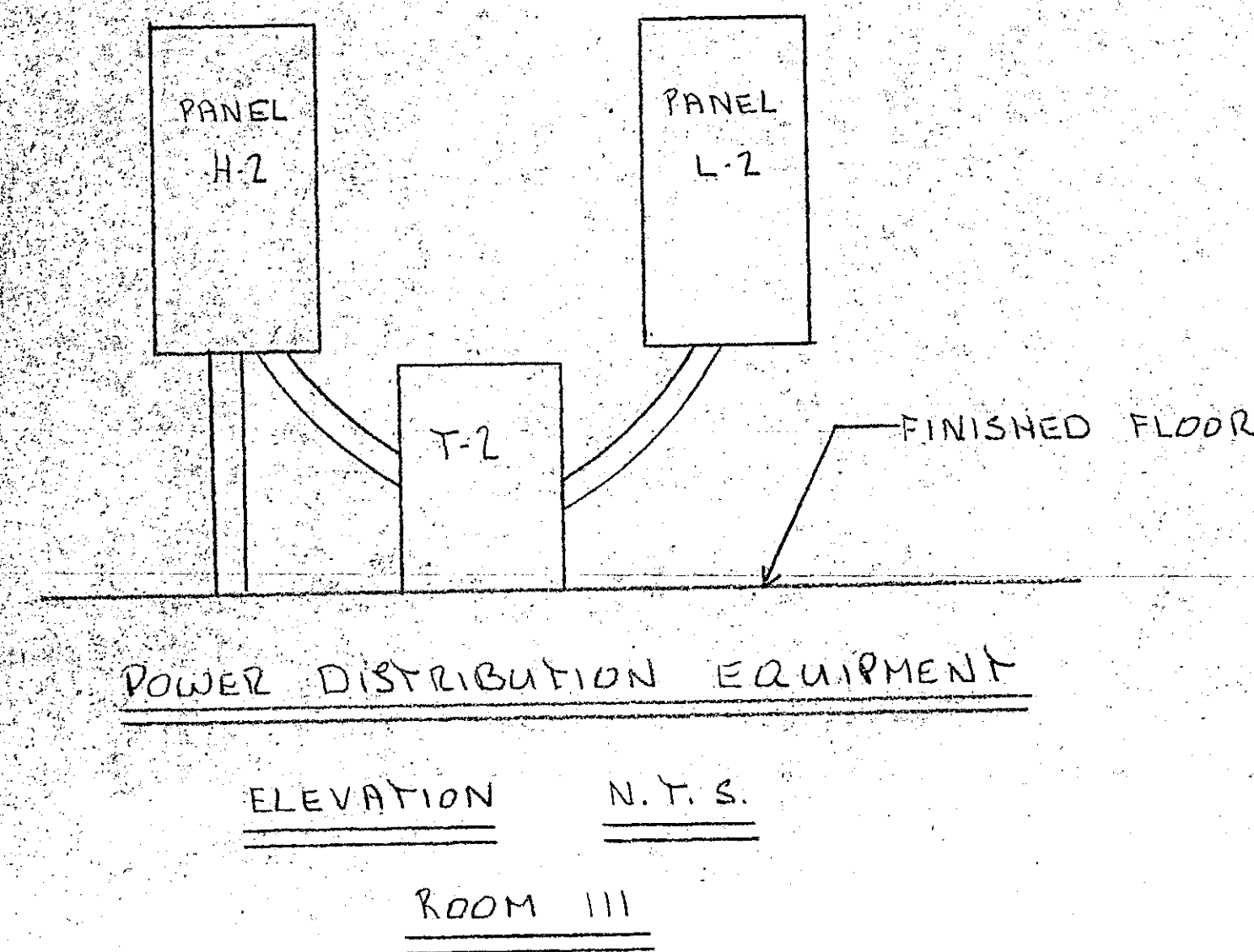
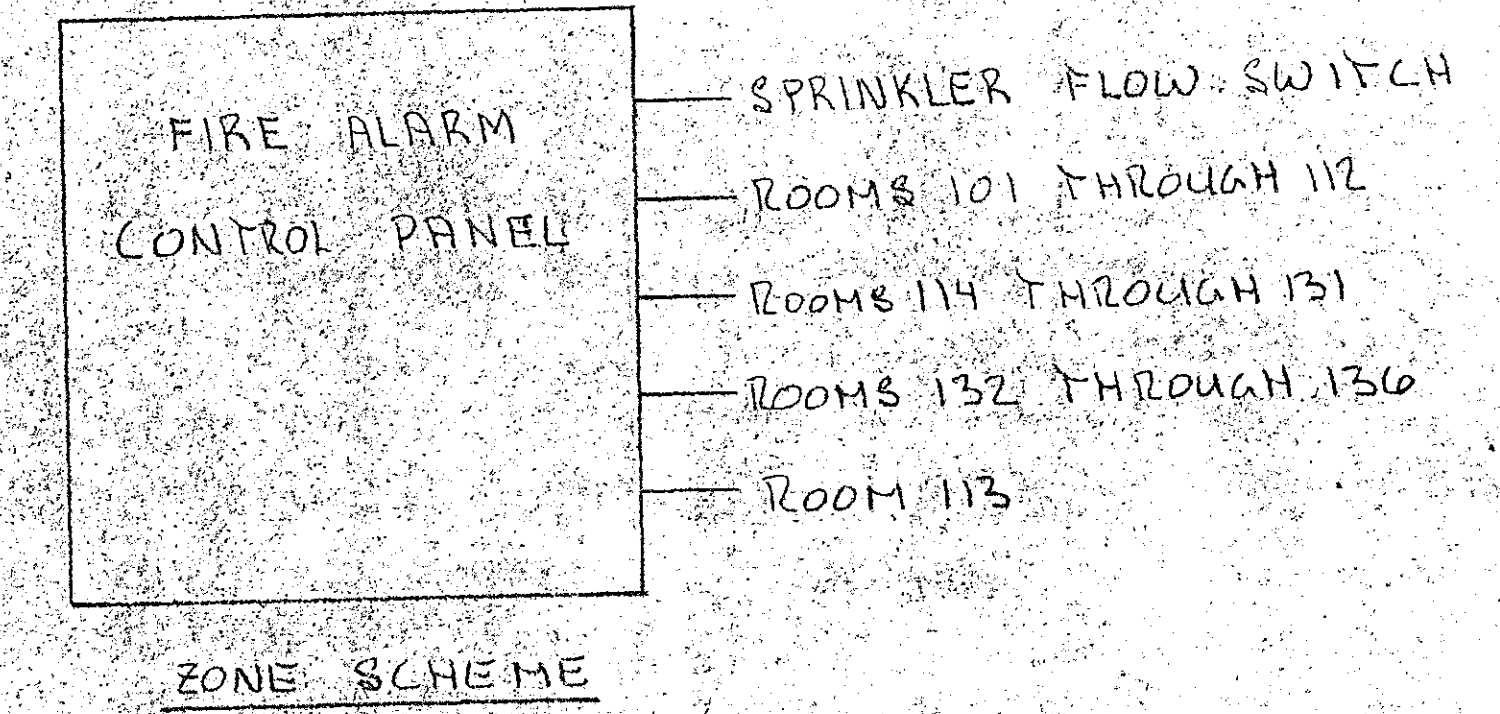

ITEM	EQUIPMENT	VOLTS	HP/KW/AMPS	PHASE	MISC.
1	SHOWER EXHAUSTER	120	1/20	1	CIRCUIT WITH SHOWER LIGHTS
2	TOILET EXHAUSTER	120	1/40	1	CIRCUIT WITH TOILET LIGHTS
3	CONCESSION EXHAUST	120	1/3	1	CIRCUIT WITH CONCESSION OUTLETS
4	CABINET UNIT HEATER	208	?	1	SEE PLAN FOR CIRCUITING
5	RADIANT HEAT	120	0.1	1	SEE PLAN FOR CIRCUITING
6	COMPRESSOR #1	480	75	3	PANEL H1 CIRCUIT 13-5
7	COMPRESSOR #2	480	75	3	PANEL H1 CIRCUIT 13-5
8	CONDENSING UNIT	480	10	3	PANEL H1 CIRCUIT 7-9-11
9	REFRIGERATION PUMP	480	?	3	PANEL H1 CIRCUIT 8-10-12
10	CONDENSING UNIT PUMP	480	?	3	PANEL H1 CIRCUIT 13-15-17
11	FIRE PROTECTION COMP.	120	5	3	PANEL H1 CIRCUIT 14-16-18
12	Boilers	120		4	ONE TO L1-6; ONE TO L1-7
13	BOILER CIRCULATION PUMP	120	1	1	ONE TO L1-8; ONE TO L1-9
14	SEWAGE LIFT PUMP	480	5	3	CIRCUIT TO H1 13-5
15	WALL EXHAUSTERS	120	1/3	1	ONE TO L1-10; ONE TO L1-11
16	Boilers	120	0.2	1	ONE TO L1-10; ONE TO L1-11

- PROVIDE LIGHTED HANDLE TOGGLE SWITCH CONTROL IN CONCESSION
- PROVIDE COMMON FEED TO BOTH COMPRESSORS; 3#250 TO 250AMP C.B.
- USE #10 WIRE

SCALE NONE	APPROVED BY	DRAWN BY
DATE 7/29/88		C-267200
CLIFTON PARK ARENA		
CW DAVIS SUPPLY CO, INC. 1425 ERIE BLVD, SYRACUSE, NY 13210		DRAWING NUMBER E-3