

ADDENDUM NO. 1
TO
Proposed Access Improvements For
41 Acre Preserve
Town of Clifton Park

DATE OF ISSUE: December 5, 2025

TO: PROSPECTIVE BIDDERS OF RECORD

Addendum No. 1 is being sent out to all plan holders.

- A. This addendum shall be considered part of the bid documents for the above referenced project as though it had been issued at the same time and shall be incorporated integrally therewith. Where provisions of the following supplementary data differ from those of the original bid documents, this Addendum shall govern and take precedence.
- B. Bidders are hereby notified that they shall make any necessary adjustments in their estimates as a result of this Addendum. It will be construed that each bidder's proposal is submitted with full knowledge of all modifications and supplemental data specified herein.

THE CONTRACT DOCUMENTS AND SPECIFICATIONS, INCLUDING THE CONTRACT DRAWINGS ARE HEREBY MODIFIED BY THE FOLLOWING ITEMS:

Item #1: Guide Rail :

Sheets C-400 & C-600 have been updated with added information for the guide rail to be installed.

End of Addendum No.01

PROPOSED ACCESS IMPROVEMENTS FOR

41 ACRE PRESERVE - RIVERVIEW ROAD

APPLICANT/OWNER:
TOWN OF CLIFTON PARK
RIVERVIEW ROAD
TOWN OF CLIFTON PARK, SARATOGA COUNTY, NEW YORK

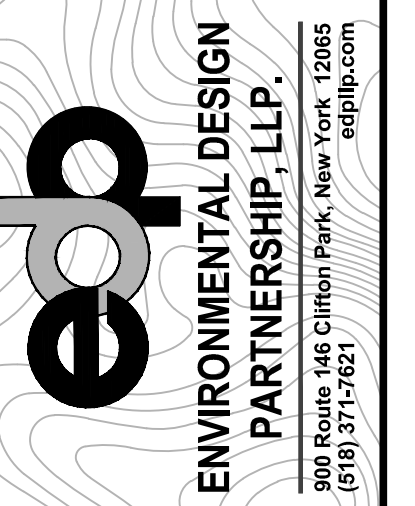

**PROPOSED PARK ACCESS FOR
41 ACRE PRESERVE - RIVERVIEW ROAD**
OWNER: TOWN OF CLIFTON PARK
RIVERVIEW ROAD
TOWN OF CLIFTON PARK
SARATOGA COUNTY, NEW YORK

TAX MAP No. 282.-1-38
AUGUST 28, 2024

DRAWN BY	FR	
CHECK BY	JL	
EDP PROJECT NUMBER	15810	
<small>THE ALTERATION OF THESE DOCUMENTS IN ANY MANNER SHALL BE UNDER THE DIRECT SUPERVISION OF A LICENSED PROFESSIONAL ENGINEER FOR AN ENVIRONMENTAL ENGINEER OR A LICENSED ARCHITECT OR SURVEYOR FOR A SURVEYOR. IS A VIOLATION OF THE NEW YORK STATE EDUCATION LAW AND/OR REGULATIONS AND IS A CLASS "A" VIOLATION.</small>		
REVISION	DATE	BY
REVISIONS PER TOWN COMMENTS	10-16-2024	FR
REVISIONS PER DEC COMMENTS	09-09-2024	FR
REVISIONS PER DEC COMMENTS	09-23-2024	FR
REVISIONS PER DEC COMMENTS	12-4-2024	JL
ADDENDUM No.1		



SCALE:
AS NOTED

**NOT FOR
CONSTRUCTION**

SHEET TITLE:
COVER SHEET

SHEET:
C-100

Sheet Number	Sheet Title
C-100	COVER SHEET
C-200	EXISTING CONDITIONS
C-300	TREE CLEARING AND REMOVALS PLAN
C-400	GRADING PLAN
C-500	EROSION AND SEDIMENT CONTROL PLAN
C-600	SITE DETAILS
WI-100	WETLAND IMPACT PLAN

RECORD OF SUBMITTALS	DATE	BY

PLANS PREPARED BY:

ENVIRONMENTAL DESIGN
PARTNERSHIP, LLP.
900 Route 146 Clifton Park, New York 12065
(518) 371-7621
edp@edp.com

FOR MUNICIPAL APPROVAL ONLY - NOT INTENDED FOR CONSTRUCTION

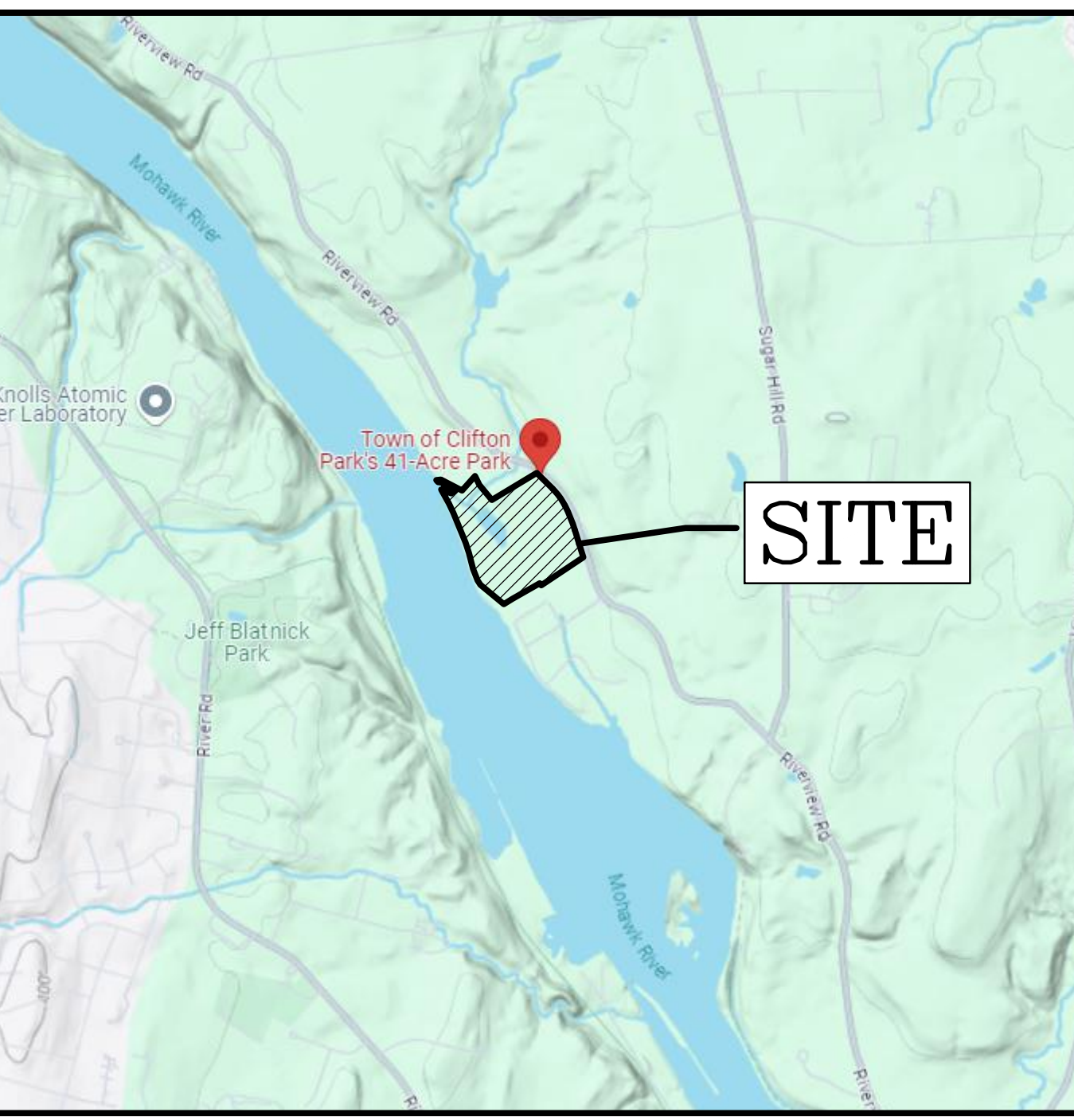

SITE LOCATION MAP
SCALE: 1" = 2000'

EXISTING ZONING	N/A
PARCEL AREA	40.75± ACRES
PROPOSED PARKING	10 SPACES
PROPOSED IMPERVIOUS AREA	0.25± ACRES
PROPOSED ROAD LENGTH	350± FT
SNOW STORAGE	ONSITE AND OFFSITE

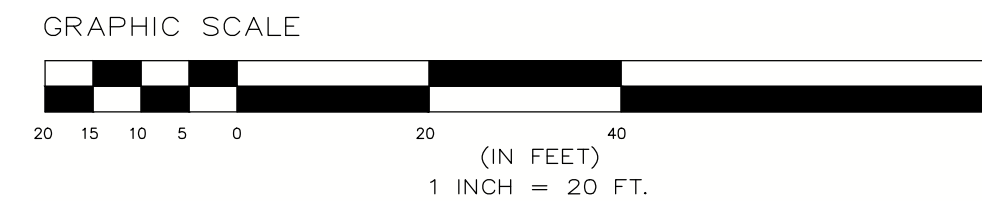

EROSION AND SEDIMENT CONTROL PLAN LEGEND

- DENOTES EXISTING GRADE
- PROPOSED ACCESS ROAD (4 C-600)
- TEMPORARY EROSION CONTROL BLANKET (ON SLOPES OVER 10%) (2 C-600)
- USACE WETLAND AREAS
- DENOTES 100-FOOT WETLAND BUFFER
- PROPOSED CONTOUR
- DENOTES PROPOSED 12 IN COMPOST FILTER SOCK (1 C-600)

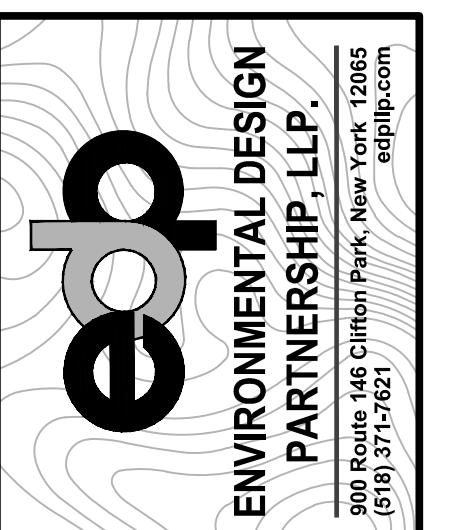
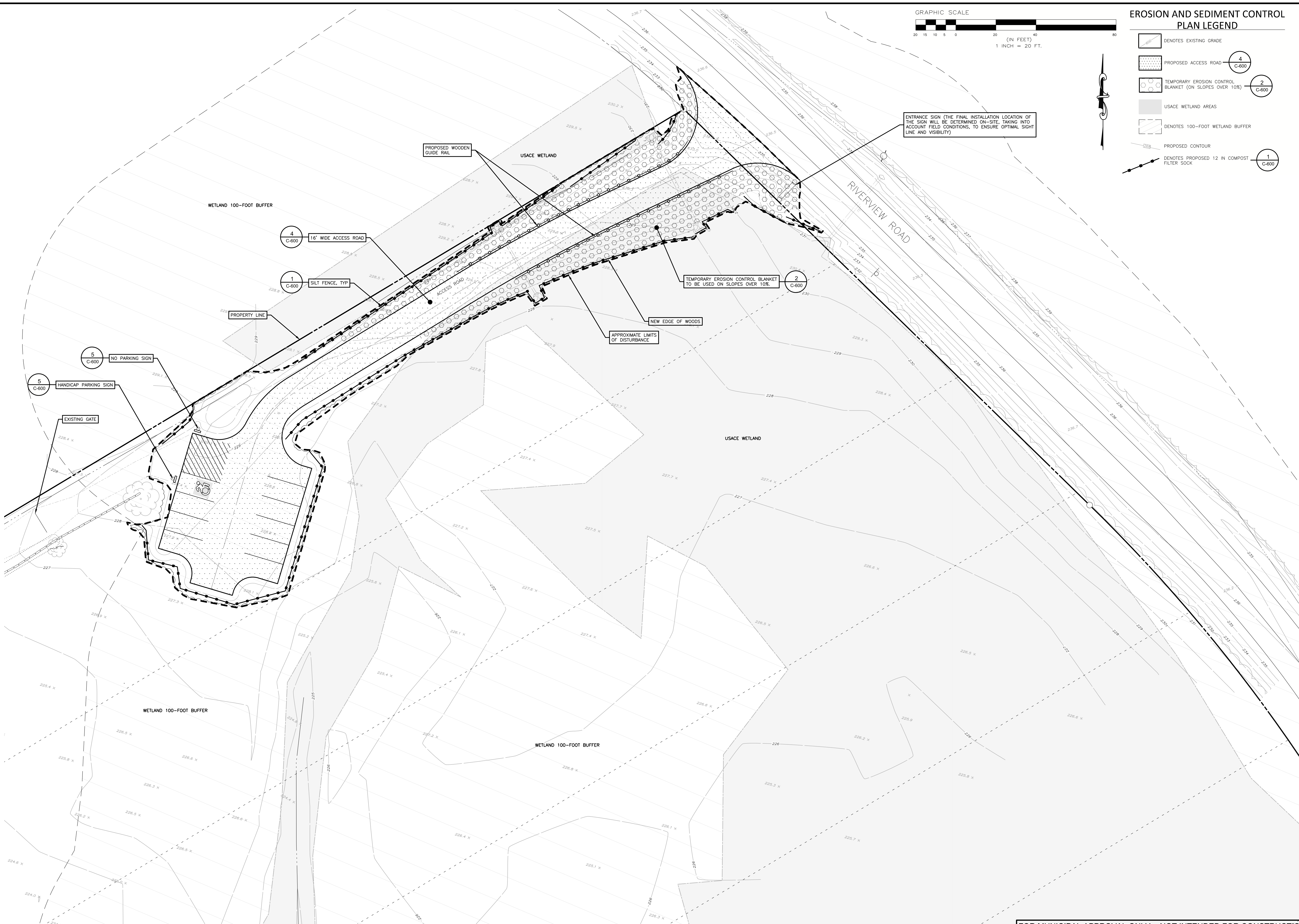

**PROPOSED PARK ACCESS FOR
41 ACRE PRESERVE - RIVERVIEW ROAD**
OWNER: TOWN OF CLIFTON PARK
RIVERVIEW ROAD
TOWN OF CLIFTON PARK
SARATOGA COUNTY, NEW YORK

TAX MAP No. 282.-1-38
AUGUST 28, 2024

DRAWN BY	FR
CHECK BY	JL
TOP PROJECT NUMBER	15810
<small>THE ALTERATION OF THESE DOCUMENTS IN ANY MANNER WITHOUT THE DIRECT SUPERVISION OF A LICENSED PROFESSIONAL ENGINEER FOR AN ENVIRONMENTAL DESIGN PARTNERSHIP, LLP IS A VIOLATION OF THE NEW YORK STATE EDUCATION LAW AND/OR REGULATIONS AND IS A CLASS "A" VIOLATION.</small>	
REVISION	DATE
REVISIONS PER TOWN COMMENTS	11-16-2024 FR
REVISIONS PER DEC COMMENTS	09-09-2024 FR
REVISIONS PER DEC COMMENTS	09-23-2024 FR
ADDENDUM No.1	12-4-2025 JL

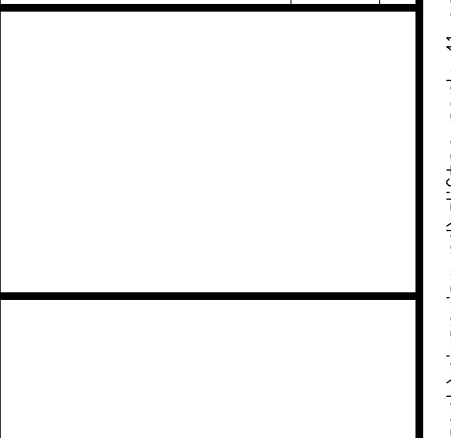

SCALE:
1" = 20'

NOT FOR CONSTRUCTION

SHEET TITLE:
EROSION AND SEDIMENT CONTROL PLAN

SHEET:
C-500

C:\workfiles\environmental\design\partnership\sharepoint\site - documents\04 - 2825\040599M.dwg Dec 04, 2025 09:01:59PM

SILT FENCE GENERAL NOTES:

- SILT FENCE SHALL BE PLACED A MINIMUM OF 5 FT. FROM TOE OF SLOPE, 10 FT. PREFERRED, TO PROVIDE ADEQUATE AREA FOR SEDIMENT STORAGE AND FACILITATE MAINTENANCE OF SEDIMENT CONTAINMENT AREA.
- POSTS MAY BE 1.25"x1.25" (MINIMUM) HARDWOOD, TYPICALLY, FOR WIRE MESH BACK USE 2"x2" NOM. HARDWOOD, OR STEEL "T" OR "U" POSTS (1lb per lf). SILT FENCE SHALL BE WOVEN GEOTEXTILE FABRIC(GEOTEX 2130 OR EQUAL).
- SILT FENCE ASSEMBLY MAY HAVE 4 FT. OR 6 FT. POST SPACING, AND MAY OR MAY NOT HAVE MESH REINFORCEMENT. SENSITIVE AREAS TO BE PROTECTED MAY NEED TO BE REINFORCED BY USING HEAVY WIRE FENCING FOR ADDED SUPPORT TO PREVENT COLLAPSE.
- THE BOTTOM EDGE OF SILT FENCE SHALL BE BURIED A MINIMUM OF 6" BELOW GROUND, THE FENCE SHALL BE INSTALLED WITH THE POSTS ON THE DOWNSTREAM SIDE OF THE FABRIC.
- MAXIMUM ALLOWABLE SLOPE LENGTHS CONTRIBUTING RUNOFF TO A SILT FENCE PLACED ON A SLOPE ARE:

SLOPE STEEPNESS	MAXIMUM LENGTH (ft.)
2:1	25
3:1	50
4:1	75
5:1 OR FLATTER	100

- MAXIMUM DRAINAGE AREA FOR OVERLAND FLOW TO A SILT FENCE SHALL NOT EXCEED 400 SQ. YD. PER 100 FEET OF FENCE, WITH MAXIMUM PONDING DEPTH OF 1.5 FEET BEHIND THE FENCE, AND EROSION WOULD ACCRUE IN THE FORM OF SHEET EROSION, AND THERE IS NO CONCENTRATION OF WATER FLOWING TO THE BARRIER.
- MEASURES SHALL BE INSPECTED EVERY SEVEN (7) CALENDAR DAYS, AFTER EACH RAINFALL OF .5" OR MORE WITHIN A 12 HOUR PERIOD, OR DAILY DURING PROLONGED RAINFALL. MEASURES SHALL BE CLEANED AND REPAIRED AS REQUIRED, AND SEDIMENT SHALL BE REMOVED WHEN ACCUMULATION REACHES ONE-THIRD OF THE MEASURE HEIGHT. SEDIMENT SHALL BE DISPOSED OF AS UNSUITABLE MATERIAL.

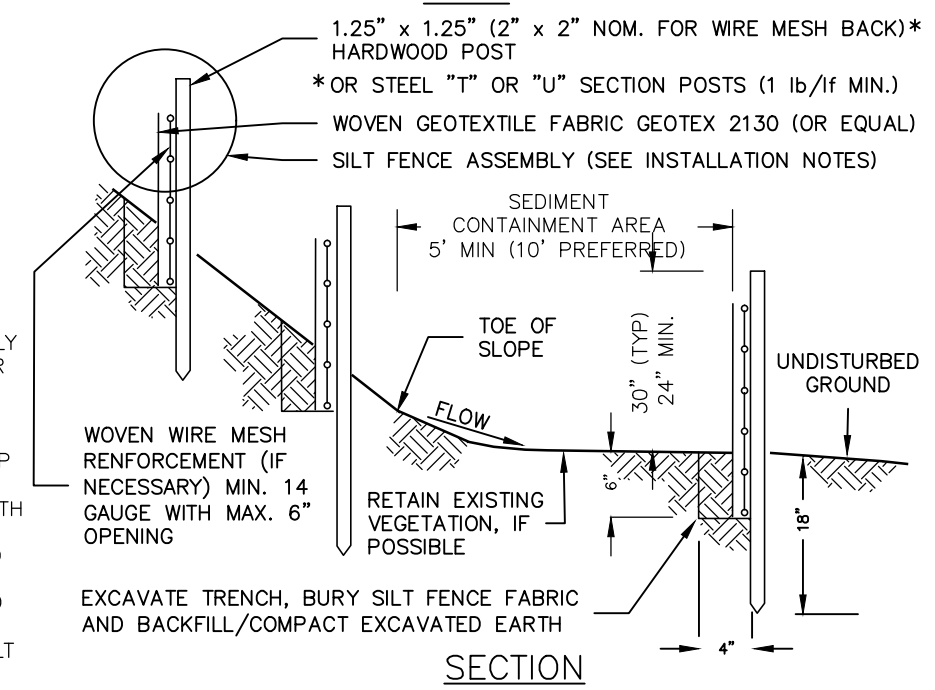
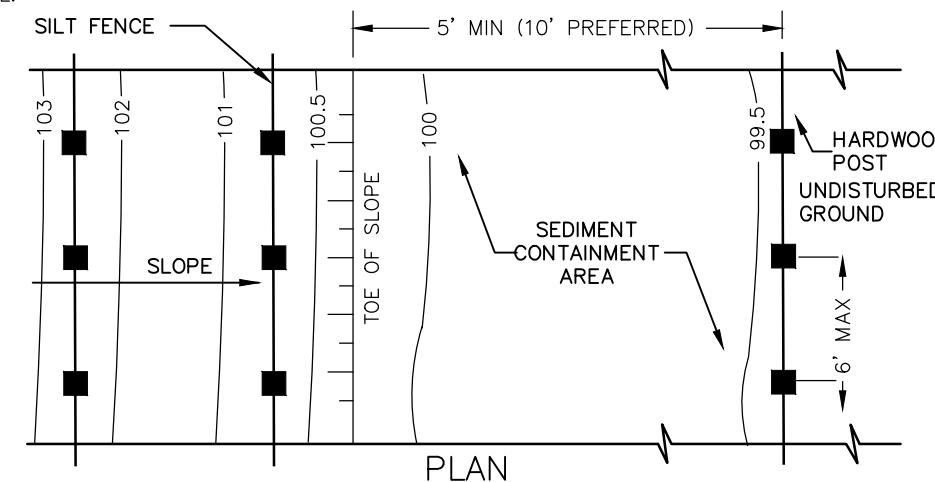

SILT FENCE INSTALLATION NOTES:

- GEOTEXTILE FABRIC AND WOVEN WIREMESH TO BE FASTENED SECURELY TO FENCE POSTS WITH WIRE TIES OR STAPLES.
- FILTER CLOTH TO BE FASTENED SECURELY TO WOVEN WIRE FENCE WITH TIES SPACES EVERY 24" AT TOP AND MID SECTION.
- WHEN TWO SECTIONS OF FILTER CLOTH ADJOIN EACH OTHER THEY SHALL BE OVERLAPPED BY SIX INCHES, FOLDED AND STAPLED.
- MAINTENANCE SHALL BE PERFORMED AS NEEDED AND MATERIAL REMOVED WHEN "BULGES" DEVELOP IN THE SILT FENCE.

1 SILT FENCE

C-600 NOT TO SCALE

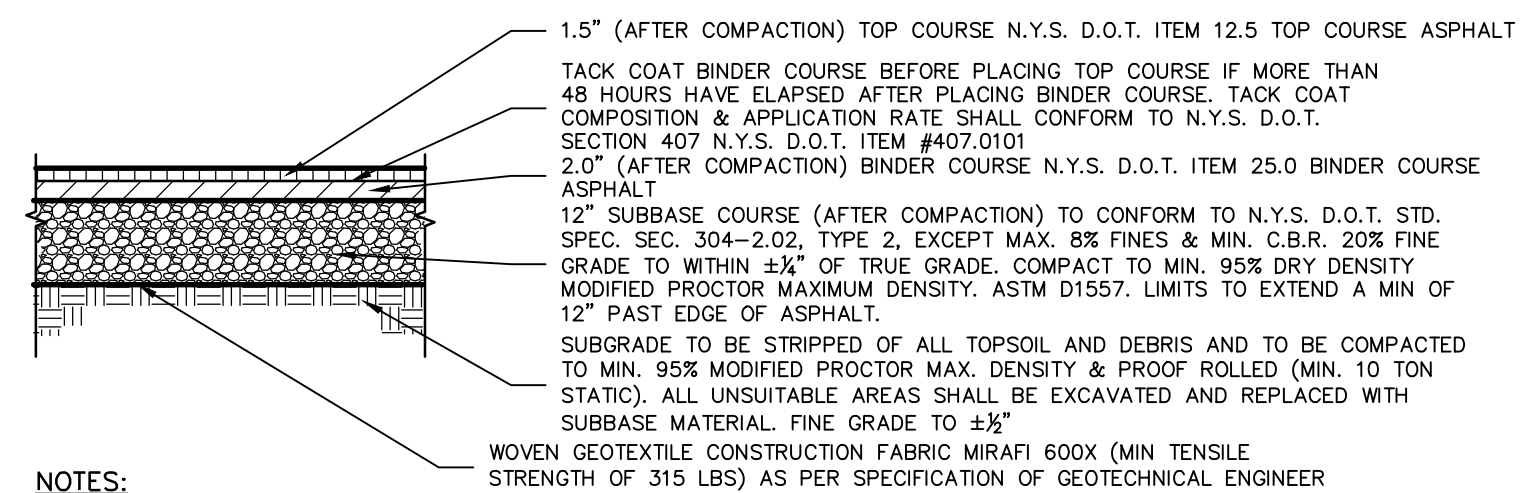

NOTES:

- THIS PRELIMINARY PAVEMENT DESIGN ASSUMES THAT EXISTING SUBGRADE CONDITIONS CONSIST OF CLEAN GRANULAR MATERIAL (SAND & GRAVEL). PRIOR TO CONSTRUCTION, THE OWNER SHALL VERIFY THE EXISTING SUBGRADE CONDITIONS USING A GEOTECHNICAL ENGINEERING CONSULTANT TO DETERMINE THE FINAL PAVEMENT DESIGN.
- ALL SUBBASE SHALL BE PROPERLY PLACED, COMPACTED AND DENSITY TESTED.
- ALL ASPHALT PAVEMENTS ARE TO BE FURNISHED AND PLACED IN ACCORDANCE WITH NYS DOT STD. SPECIFICATIONS FOR HOT MIX ASPHALT, SECTION 400.
- ASPHALT PAVEMENT COMPACTON SHALL MEET OR EXCEED 90% OF THE MAXIMUM SPECIFIC DENSITY.

4 MEDIUM DUTY PAVEMENT SECTION

C-600 NOT TO SCALE

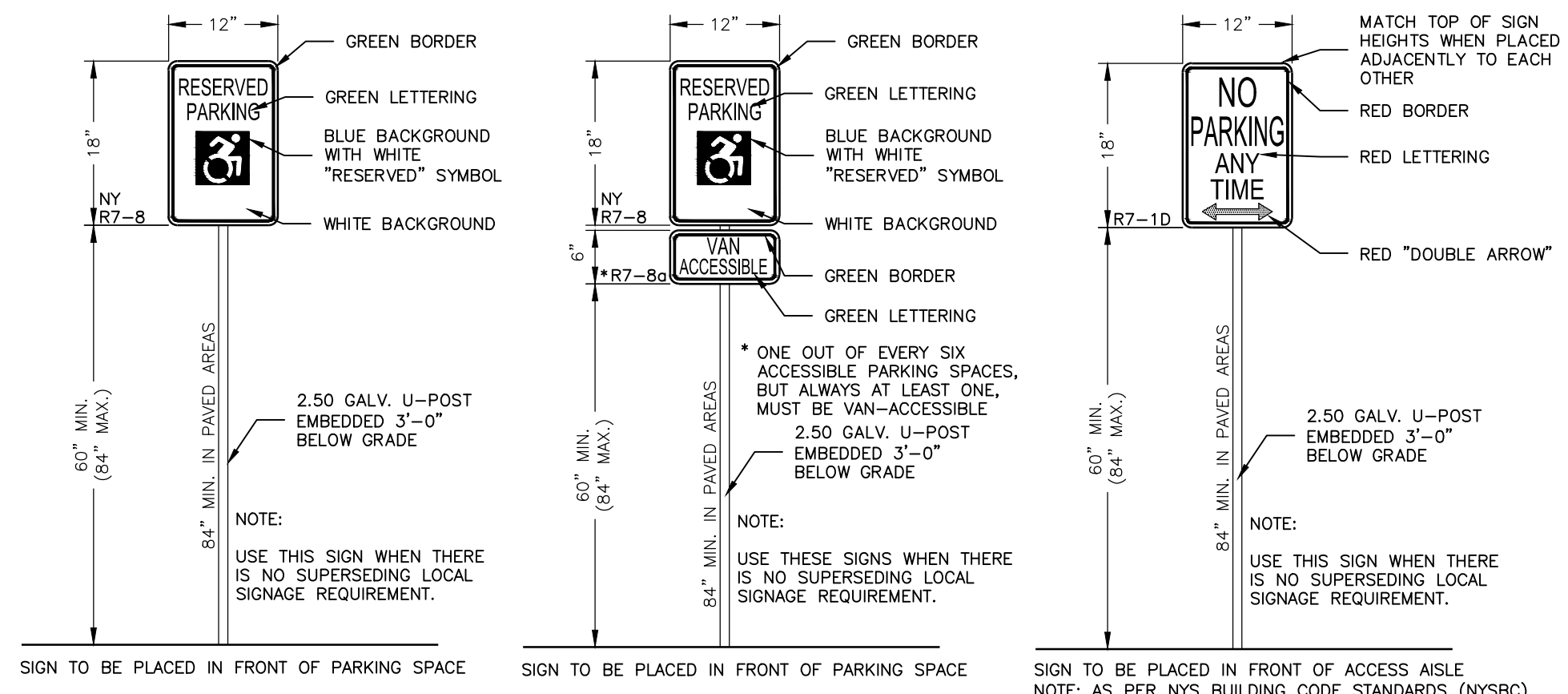

5 ADA ACCESSIBLE PARKING SIGNAGE

C-600 NOT TO SCALE

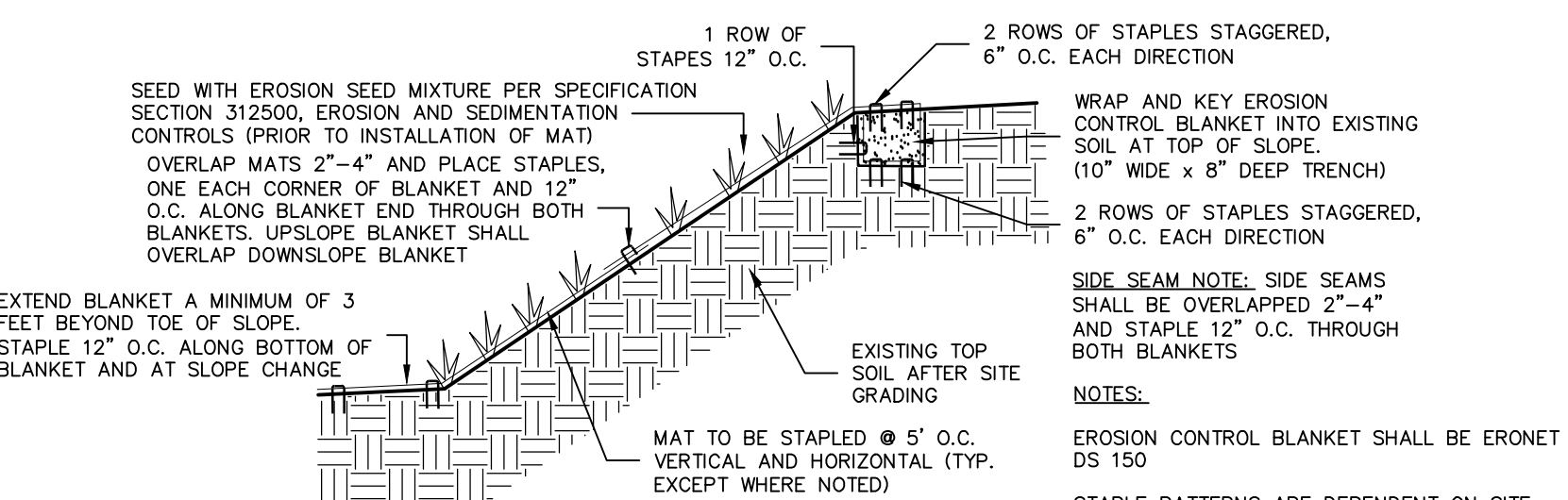

2 EROSION CONTROL BLANKET

C-600 NOT TO SCALE

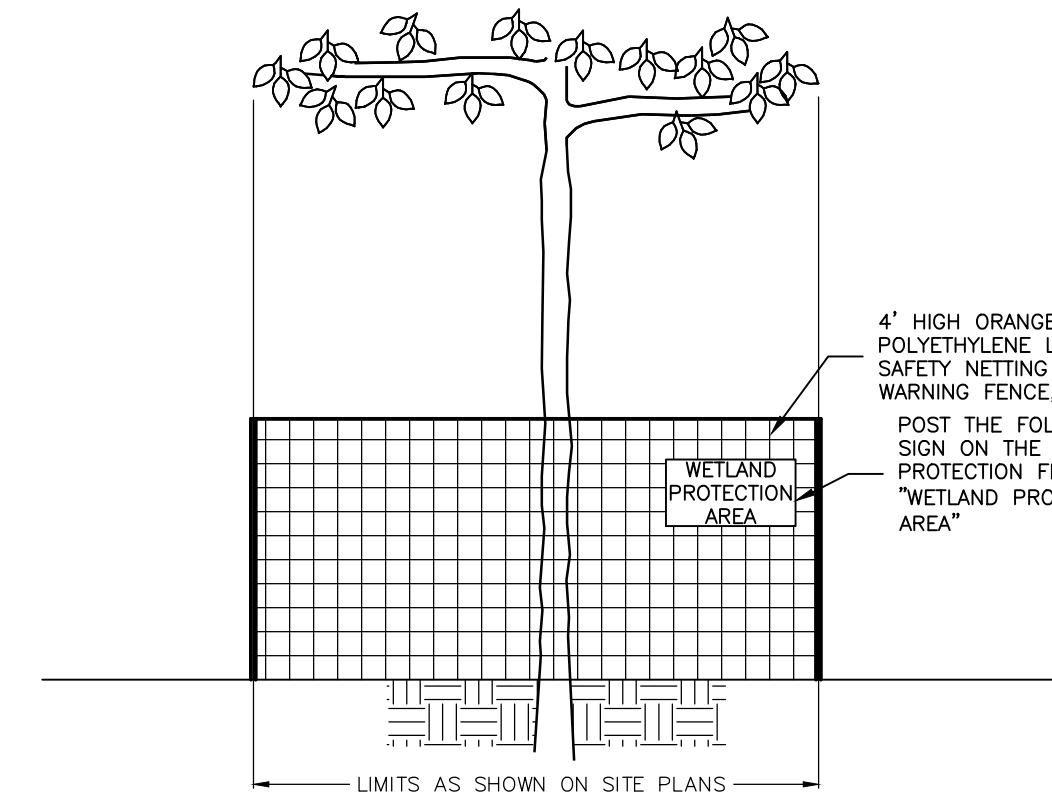

6 TREE PROTECTION DURING CONSTRUCTION

C-600 NOT TO SCALE

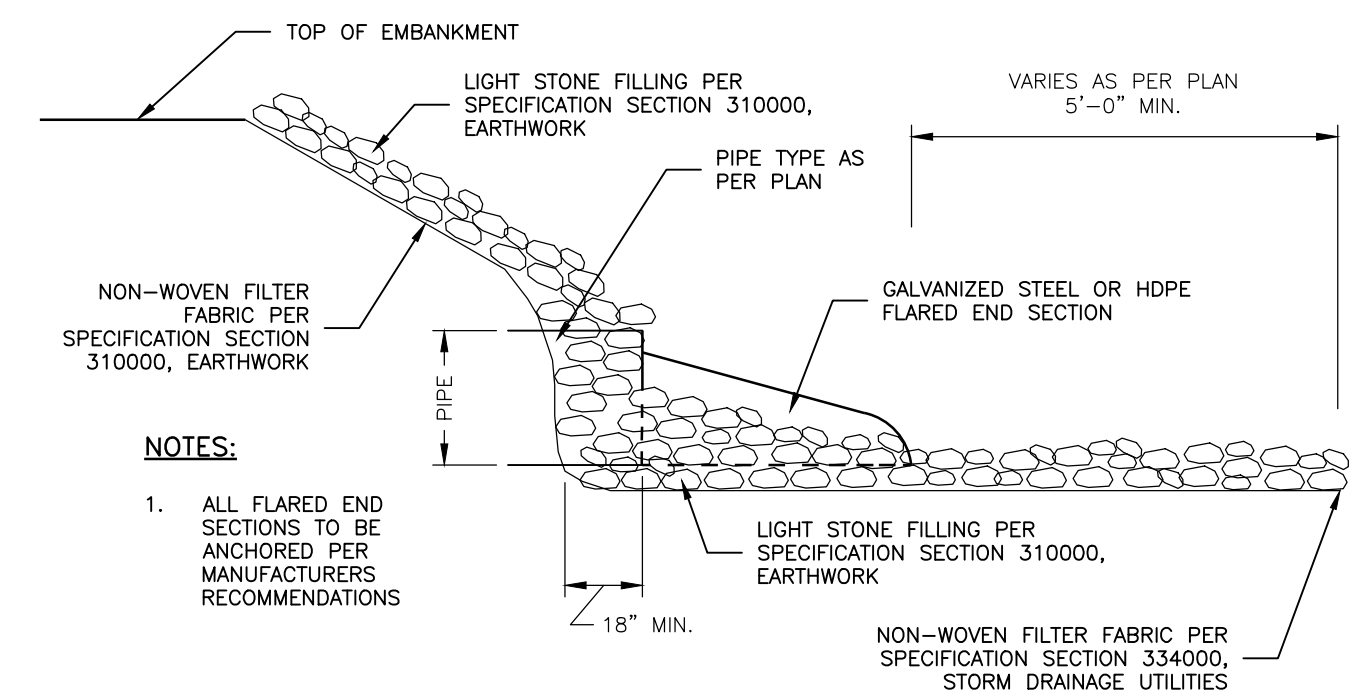

3 FLARED END SECTION

C-600 NOT TO SCALE

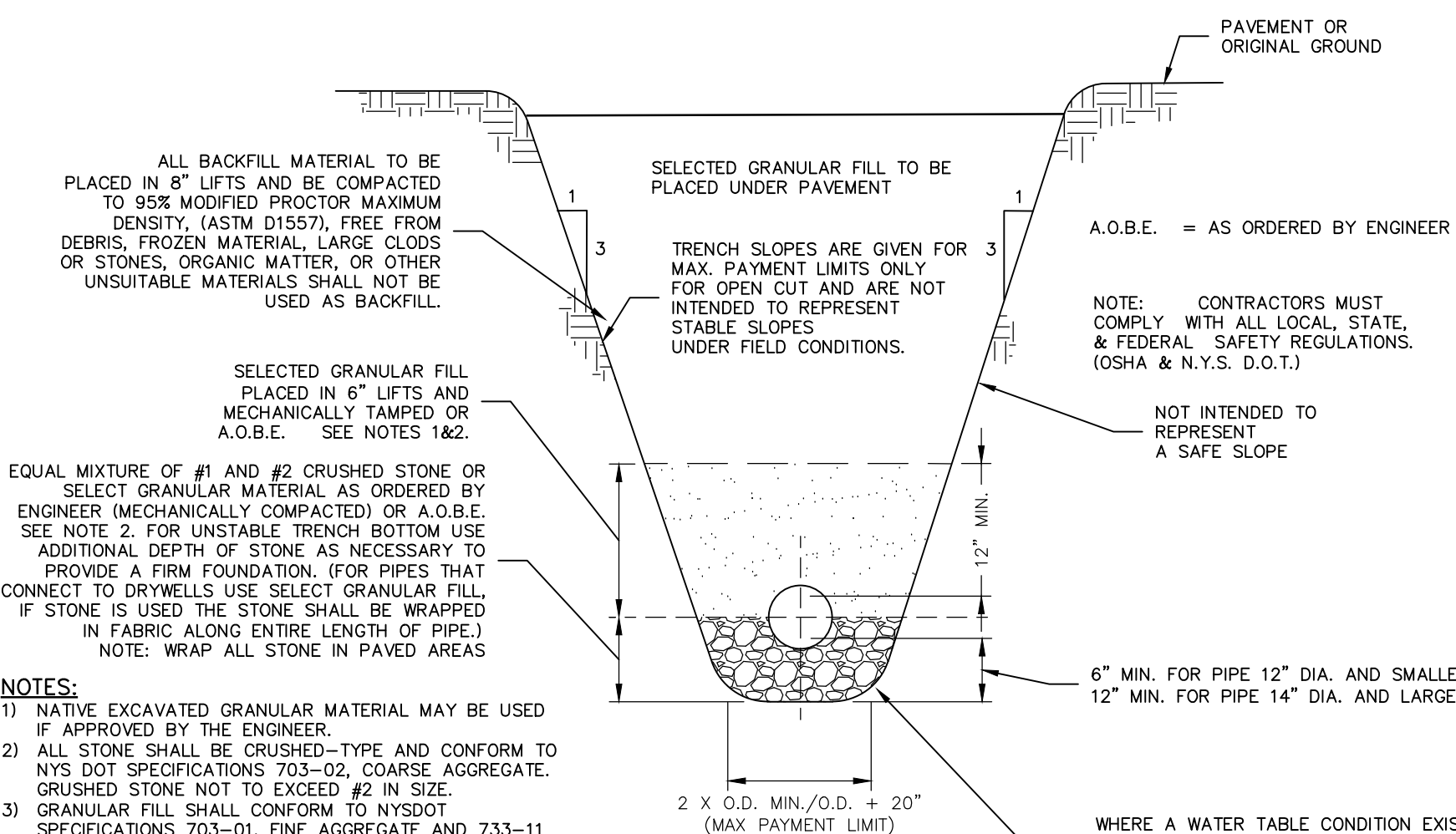

7 STORM PIPE TRENCH

C-600 NOT TO SCALE

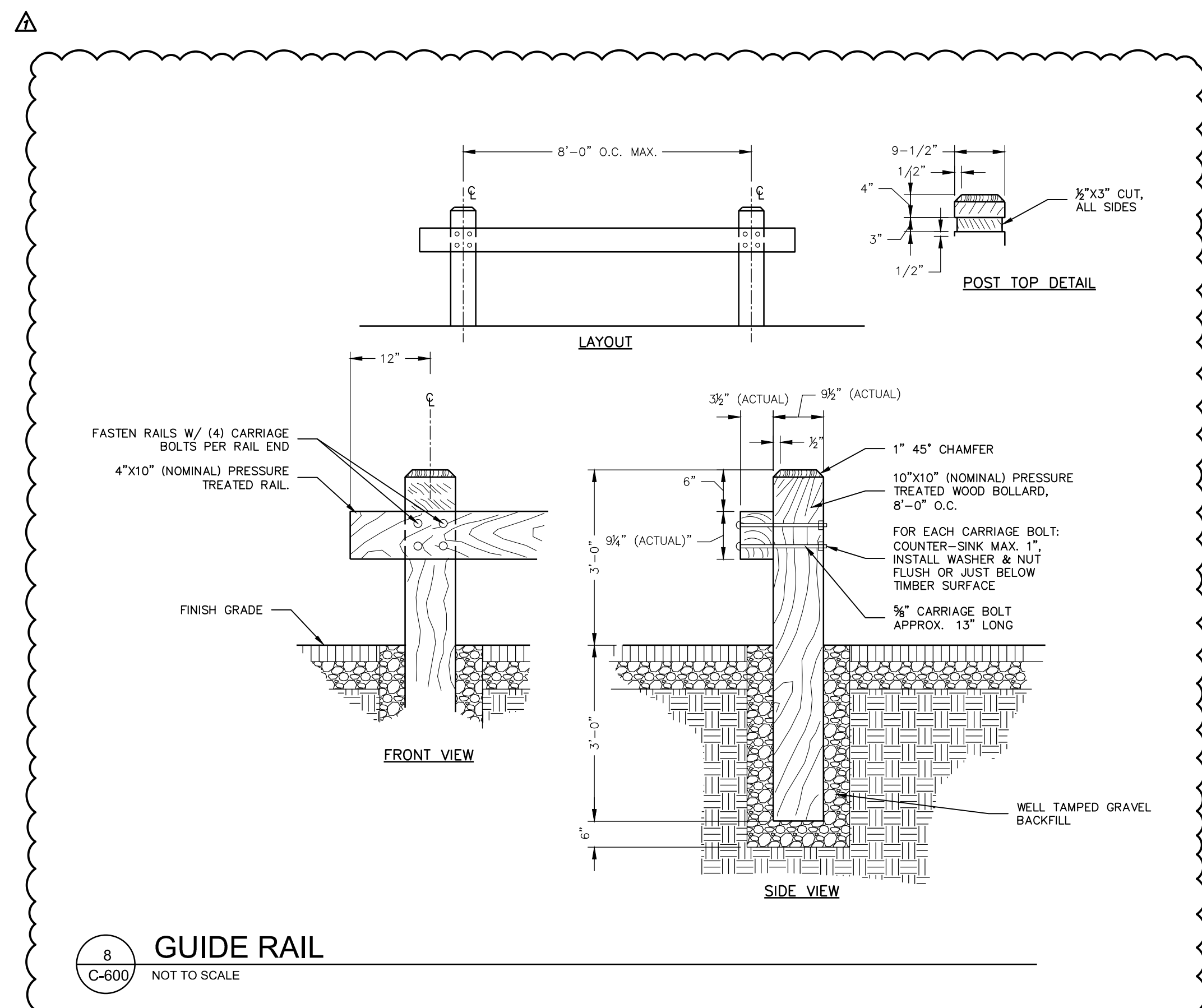

8 GUIDE RAIL

C-600 NOT TO SCALE

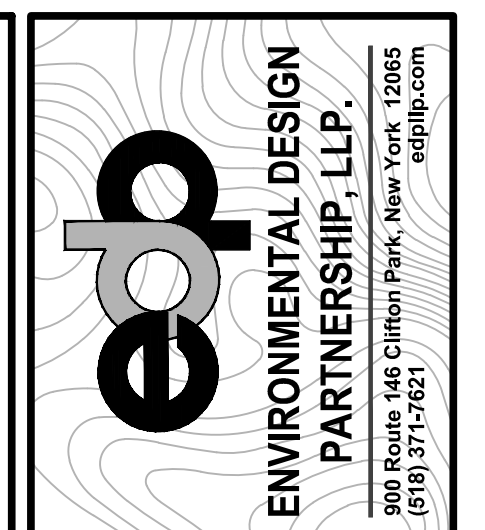

**PROPOSED PARK ACCESS FOR
41 ACRE PRESERVE - RIVERVIEW ROAD
OWNER: TOWN OF CLIFTON PARK
RIVERVIEW ROAD
TOWN OF CLIFTON PARK
SARATOGA COUNTY, NEW YORK**

TAX MAP No. 282-1-38
AUGUST 28, 2024

REVISION	DATE	BY
REVISIONS PER TOWN COMMENTS	10-16-2024	FR
REVISIONS PER DEC COMMENTS	09-09-2024	FR
REVISIONS PER DEC COMMENTS	09-23-2024	FR
ADDENDUM No.1	12-4-2025	FR



SCALE:
AS NOTED
NOT FOR CONSTRUCTION

SHEET TITLE:
SITE DETAILS

SHEET:
C-600

TAX MAP No. 282-1-38
 AUGUST 28, 2024

DRAWN BY	FR
CHECK BY	JL
EEP PROJECT NUMBER	13510
DATE	10-16-2024
REVISIONS PER TOWN COMMENTS	10-16-2024 FR
REVISIONS PER DEC COMMENTS	09-09-2025 FR
REVISIONS PER DEC COMMENTS	09-23-2025 FR
ADDENDUM No.1	02-4-2025 JL



SCALE: 1" = 20'

NOT FOR CONSTRUCTION

SHEET TITLE: WETLAND IMPACT PLAN

SHEET: WI-100

C:\workfiles\environmental\design\partnership\sharpepoint\site - documents\A-A-Z\SARATOGA\Clifton Park\riverview park\riverview park\riverview park\riverview park\WI-100.dwg Dec 04, 2025 03:02:46PM

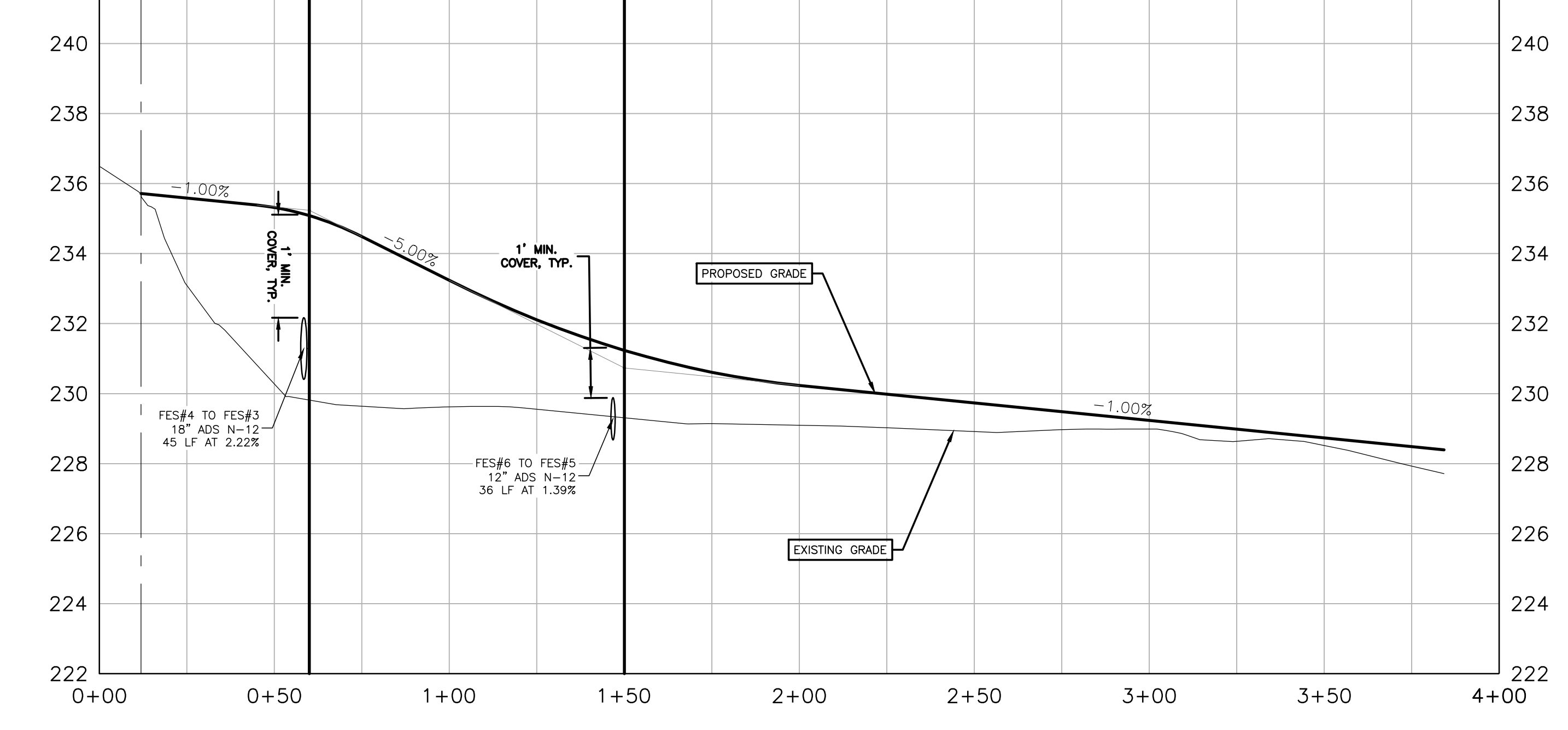
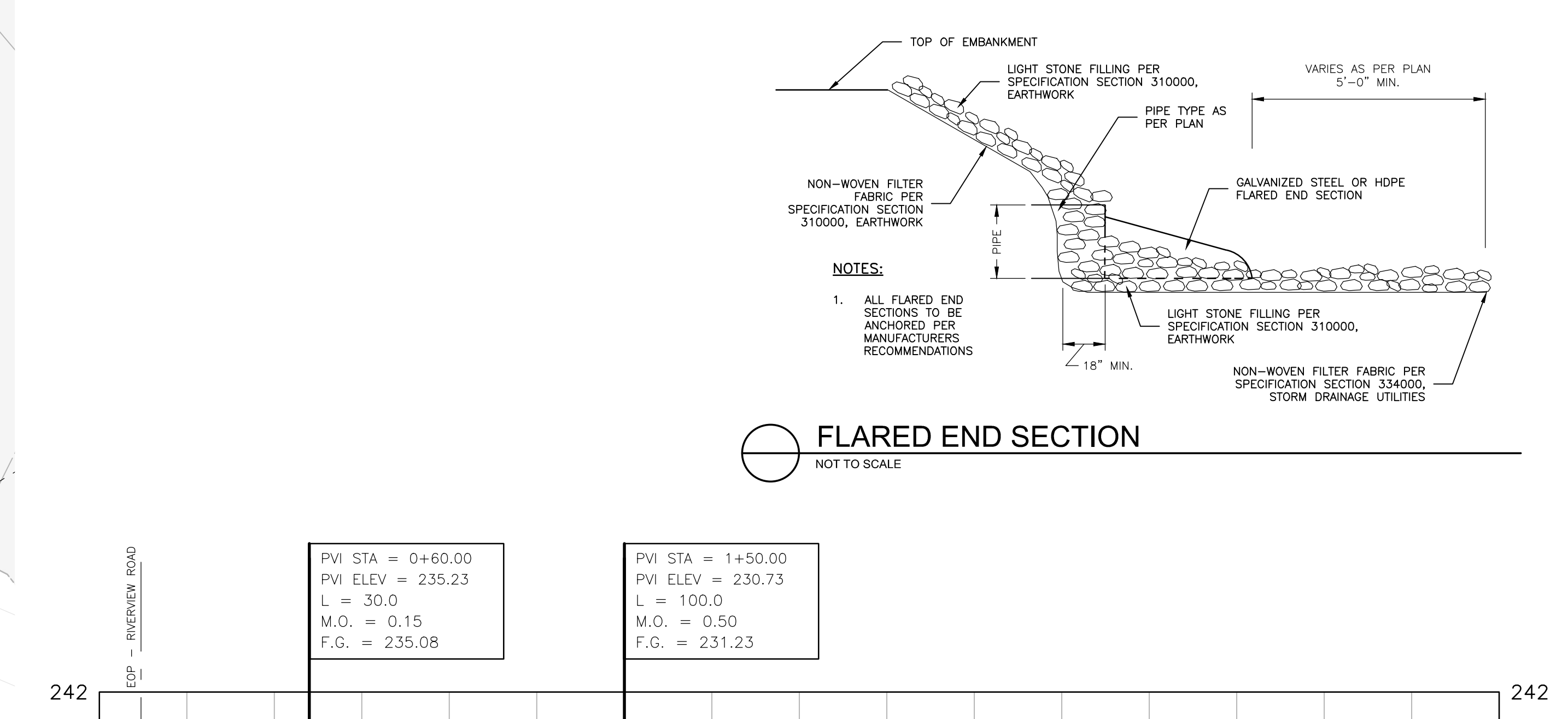
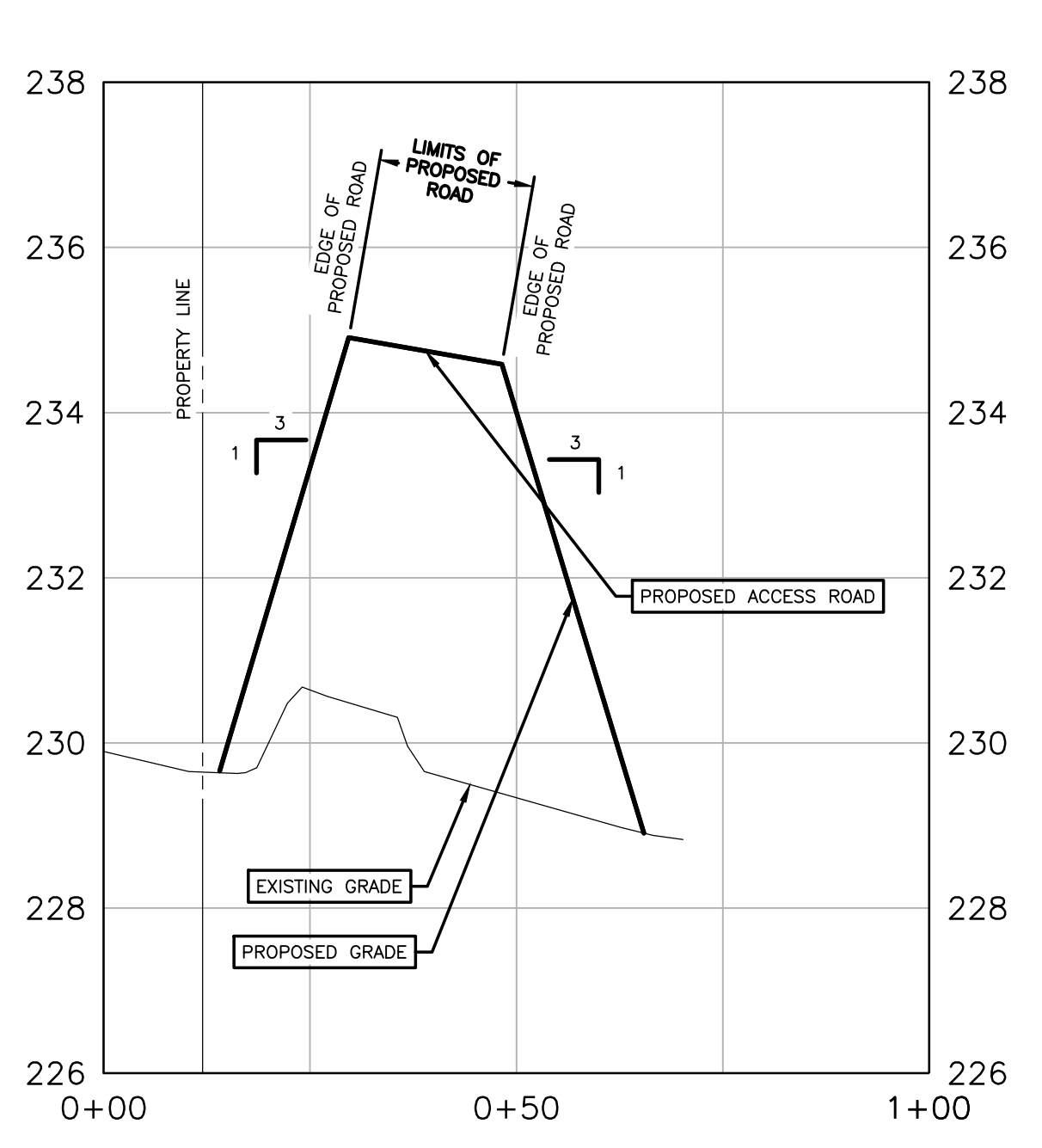
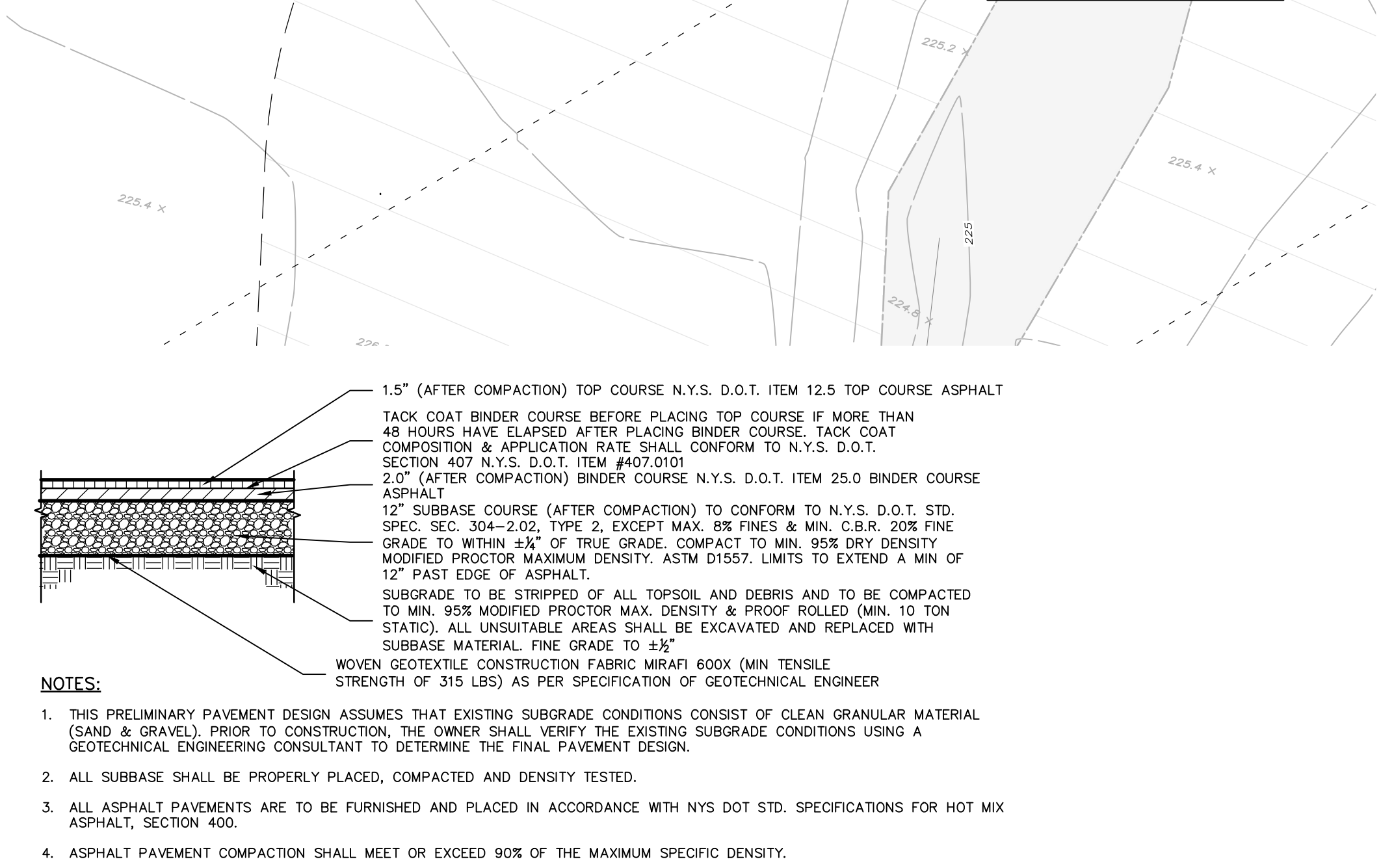
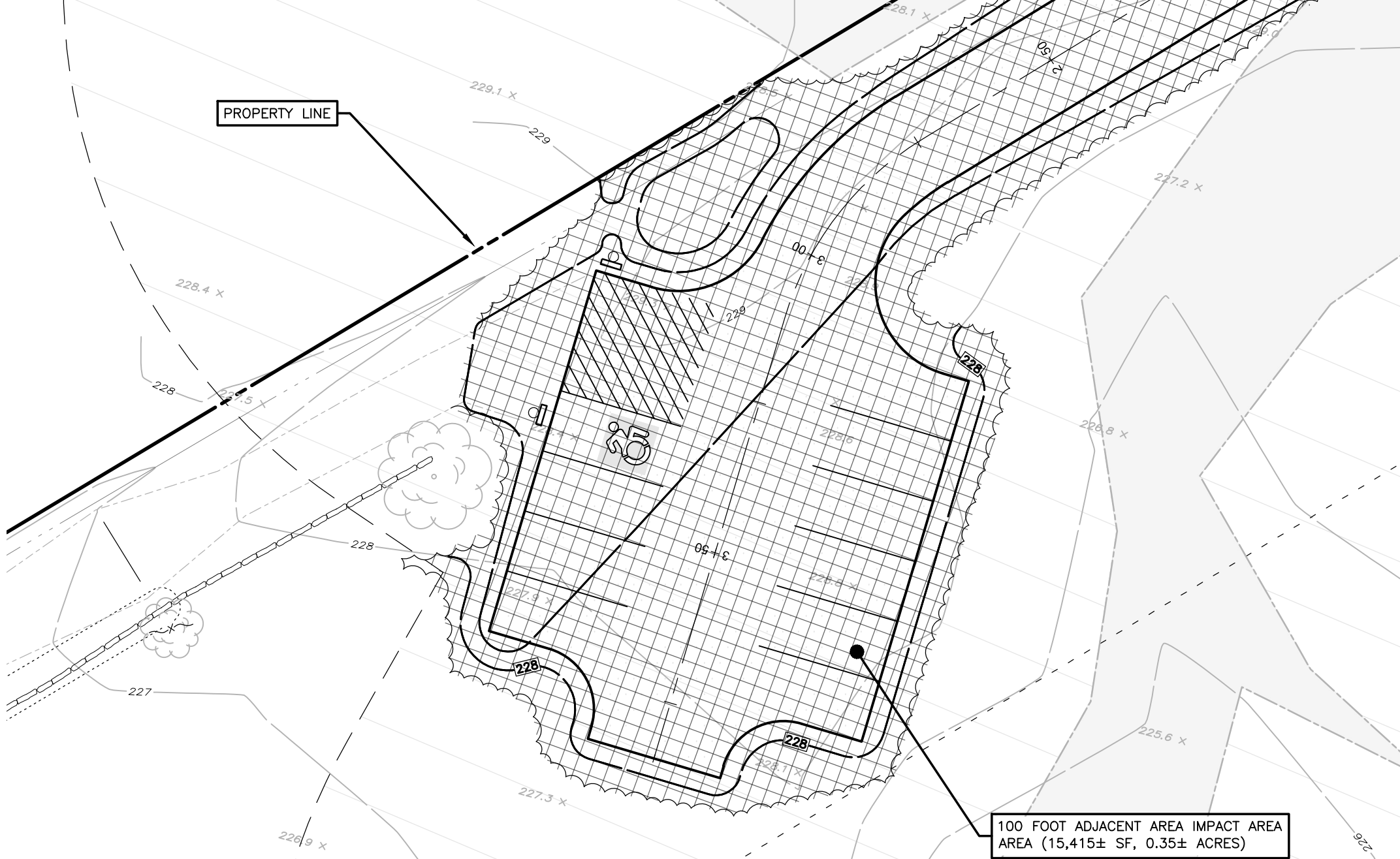
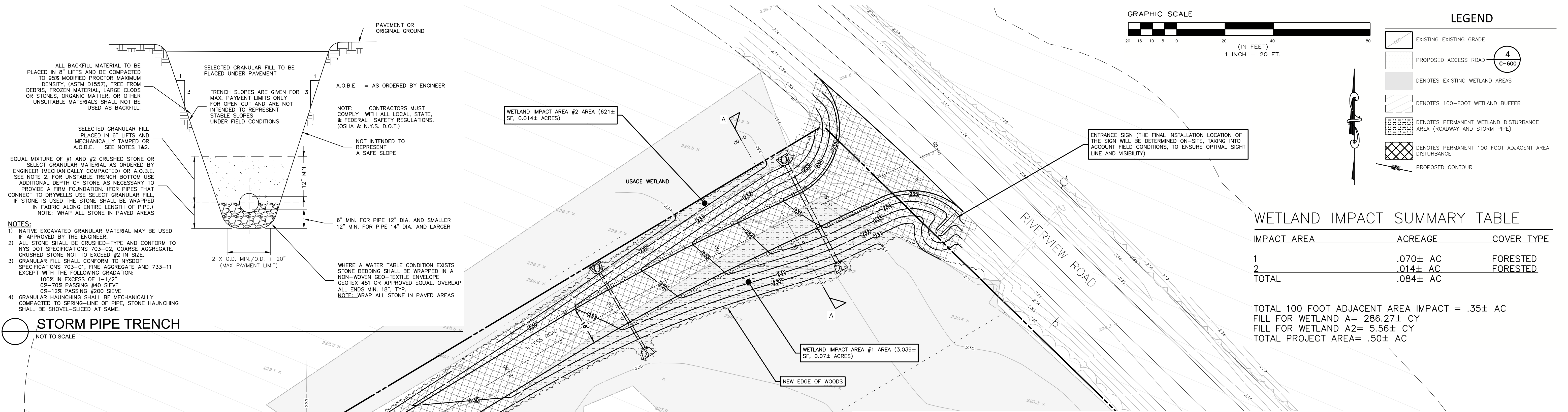

FOR MUNICIPAL APPROVAL ONLY - NOT INTENDED FOR CONSTRUCTION